

Levi Williams

East 204.68

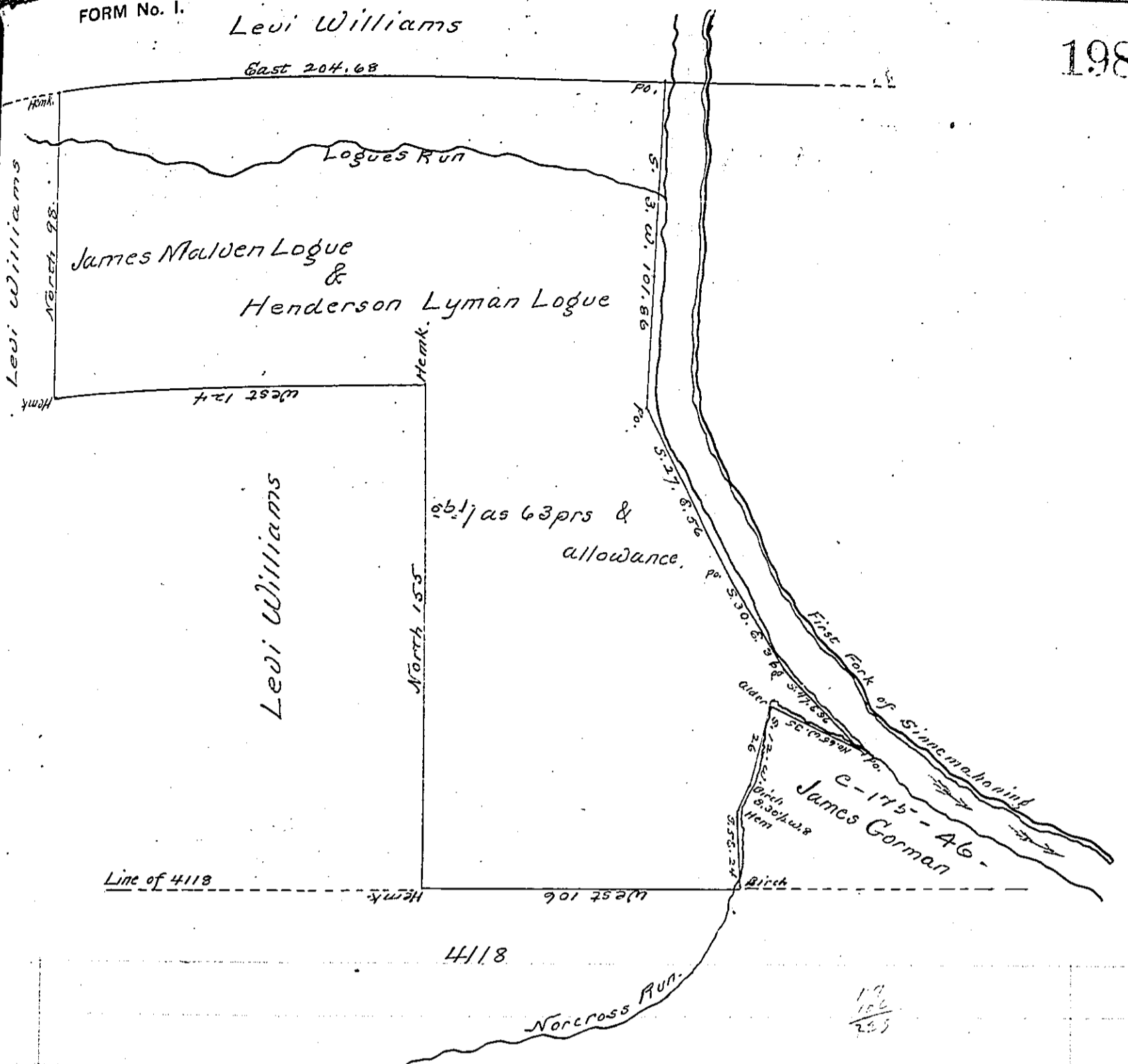

Draft of a tract of land containing Two Hundred and Seven acres and Sixty three perches and allowance of six be. cont for roads. Situated in Snow Township in the County of Cameron, Surveyed the Eighth (8th) day of November 1873, in pursuance of a warrant granted to James Malden Logue and Henderson Lyman Logue, dated the 7th day of November 1873

E. Koshung C.S.

To Robert B. Beath
Surveyor General.

IN TESTIMONY that the above is a copy of the original remaining on file in the Department of Internal Affairs of Pennsylvania, made conformably to an Act of Assembly approved the 16th day of February, 1833, I have hereunto set my Hand and caused the Seal of said Department to be affixed at Harrisburg, this first day of April 1902

James W. Latta
Secretary of Internal Affairs.